

1591MF Enclosure

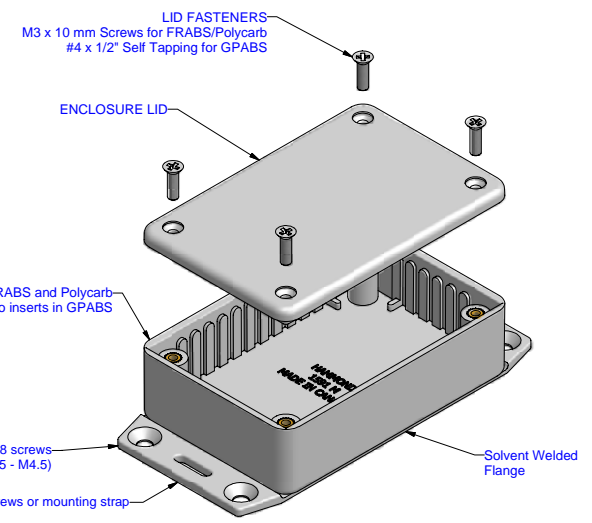

EXPLODED VIEW OF ASSEMBLY

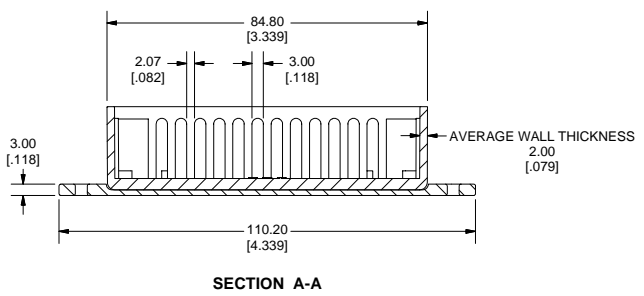
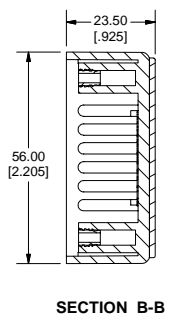
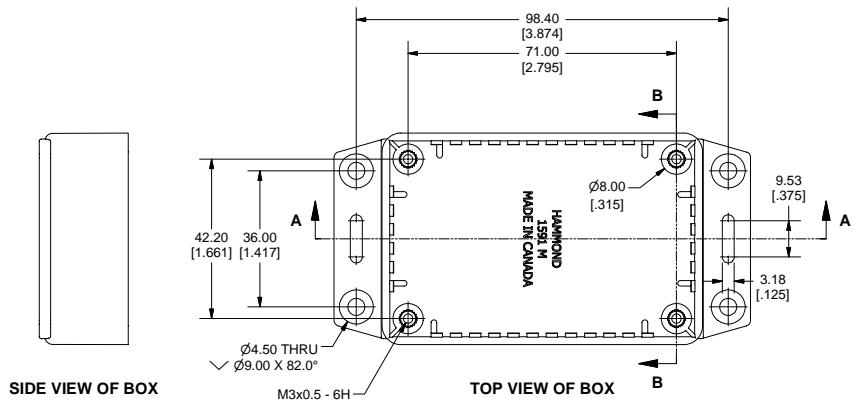
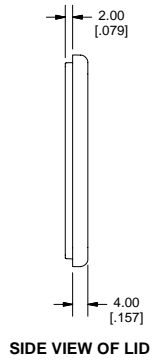
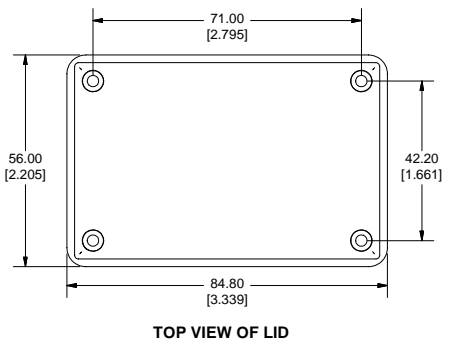
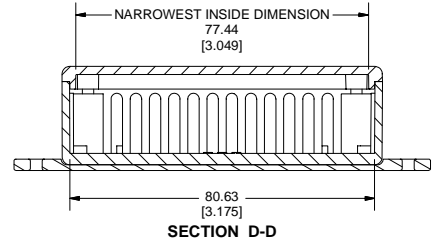
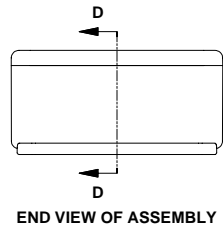
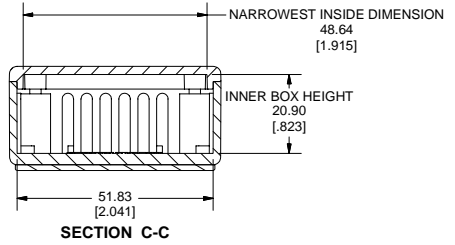
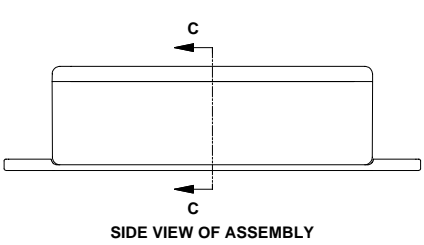

Note:
Enclosures can be Factory Modified (Milling, Drilling, Printing etc.)
Solid models of this enclosure available in STEP or IGES Format.
Contact Factory mjm@hammondmfg.com



PART NUMBERS		
1591M Flanged Box Enclosures		
Material	Colour	Part Number
FR ABS	Black	1591MF2BK
UL94 - V0	Grey	1591MF2GY
GP ABS	Black	1591MF2SBK
	Grey	1591MF2SGY
Accessories		
Description	Part Number	
PC Board Card Adapters	See Accessories Section	
Universal Use	Clear Lids - clear, flame retardant polycarbonate - Lid ONLY	1591MC
FR ABS	Replacement Screws, Flat Head Phillips Nickel Plated Pkg of 100	1591MS100
GP ABS	Self Tapping Pkg of 100	1591TS100
		1591TS100BK (Black)
		1591TS100BK (Black)
Recommended Torque on Fasteners (no lubrication)		
M3 - 0.5 x 10mm Screws		30-40 cN*m
#4 x 0.5 Screws		30-40 cN*m